

BERRY  ALLOC

/ wall&water.



_____ walls.

Discover the joy of a Scandinavian lifestyle.

Ready to be inspired?

Enjoy the simplicity and elegance of mother nature by welcoming it inside.

Erase the boundaries between indoors and outdoors.

It doesn't matter if you like traditional, sober, elegant or cozy designs. You'll find the perfect wall panel in our wide range of natural-looking designs.

Designed to create a warm and authentic atmosphere, our wall panels are made for busy, chaotic mornings, and quiet, cosy evenings.

For the kids splashing around and making a mess. For early morning routines and for late-night hot showers. For you.

Live life your way. Our walls will blend right in.

relax, it's BerryAlloc

/ wall&water.

Why choose Walls	6
Collection guide	28
Installation	32
Accessories	34
Technical overview	37

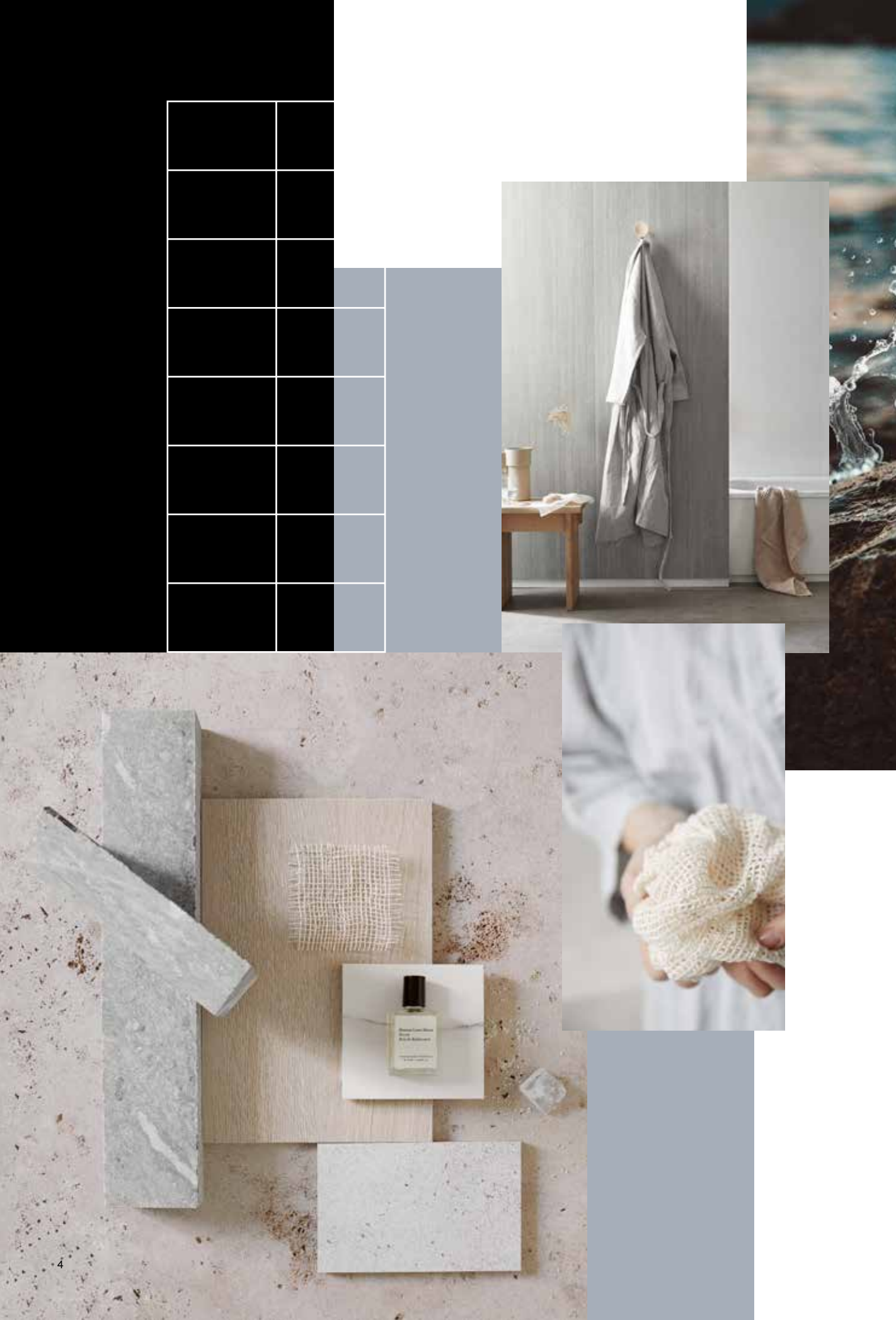

Why choose Walls?

Nothing beats the feeling of home.

Home is what you make it. That's why our collection of wall panels has a design for everyone. Because we've all made life our own.

Choose from a contemporary range of natural-looking designs and different tile sizes to give your space a new look and feel.

So, if you're on the lookout for a versatile, durable and easy way to renew your bathroom interior ... Look no further.

Turn your bathroom into a private spa. Our walls won't mind.

Go for walls and enjoy...

Lifetime warranty

Just relax, because we promise you a lifetime warranty for every BerryAlloc wall panel in your home.

Fast & easy installation

Glue or interlock, our wall panels combine ease of installation with ease of maintenance. Whether it's your first time or your daily occupation.

Waterproof

Our high-pressure Wall&Water laminate panels can withstand humid and moist environments, making them perfectly suited for bathroom use. Splash around all you want. Our wall panels are made to last.

UV-resistance

Let the sun in and don't worry about discolouring your walls. All our wall panels are UV-resistant. Their design won't change over time.

Environmentally conscious

We take environmental challenges seriously and aim to live up to the demands set for sustainable development. That's why our products are produced, used, recycled and destroyed without damage to the natural environment.



lifetime warranty



fast & easy installation



waterproof



UV-resistance



environmentally conscious



Our walls fit your interior,
your habits, your home.



**The choice is yours.
Our collection has a
design that you will love.**

**Breathe in
the charm of
the north.**



Just relax and create
a perfect sense of
well-being with
Natural Slate.

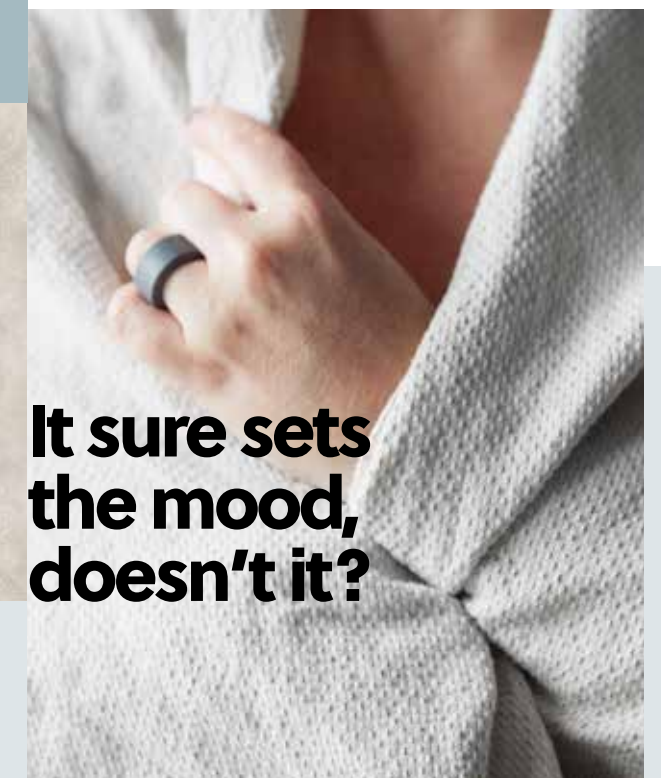

**It sure sets
the mood,
doesn't it?**

The powdery shades of Black Velvet.

The powdery shades of black give Black Velvet its distinct charcoal look. Which, in turn, bathes your bathroom in a masculine touch of understated elegance. Fill up your bathtub and experience absolute privacy while soaking next to the flickering light of a lone candle.

For those who like a sense of peace and quiet.

Our Snow White wall is timeless in style, quietly understated, simple yet sophisticated.



A timeless appeal.



The glossy surface creates a certain balance and order.

Clean crisp lines with a pared-down black and white design.





**Start your
day with a
fresh smile.**



We treat our marble
extra soft, which makes
it rich in details and
keeps it more natural.



Bring some beauty from
outside into your home.
Every single day.



Our designs are
inspired by nature.



**Relax
and feel
surrounded
by nature.**



Combine different natural elements for a mood-boosting look and feel.

Use Santorini Marble to make a bold statement.



Did you know? Most colours used in Scandinavian interiors are monochrome.

Are you a monochrome traditionalist? Then you know shiny, crisp, and even clinical is the name of the game.

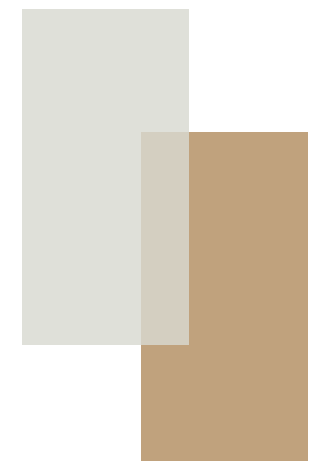



Create your own personal space.

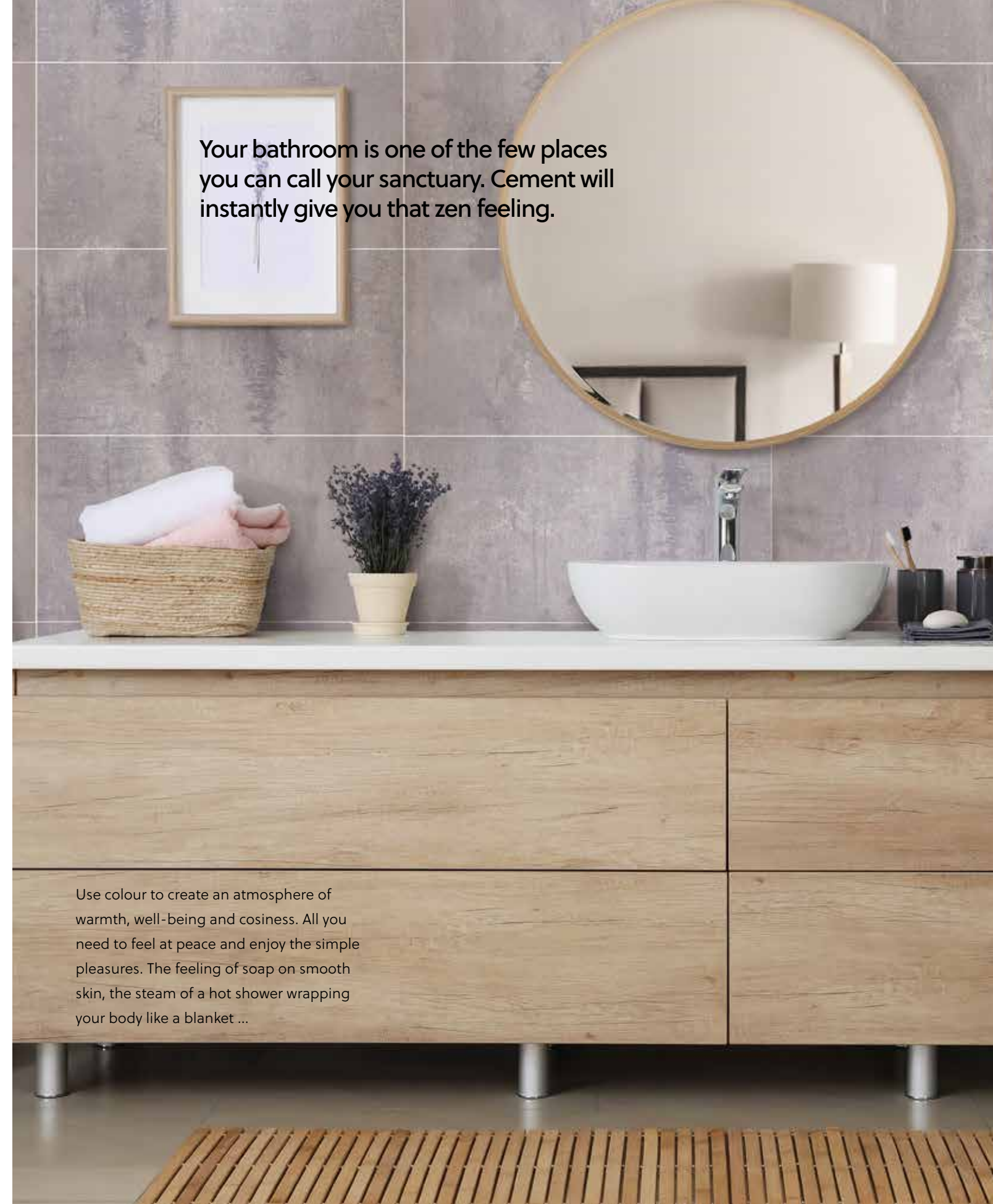

Your bathroom is one of the few places you can call your sanctuary. Cement will instantly give you that zen feeling.

Use colour to create an atmosphere of warmth, well-being and cosiness. All you need to feel at peace and enjoy the simple pleasures. The feeling of soap on smooth skin, the steam of a hot shower wrapping your body like a blanket ...



Oh, nostalgia!



Federa has that retro feeling that takes you right back to your childhood – cosy summers at grandma’s cabin and lots of happy, carefree moments.

collection guide.

There's a finish for every kind of lifestyle.

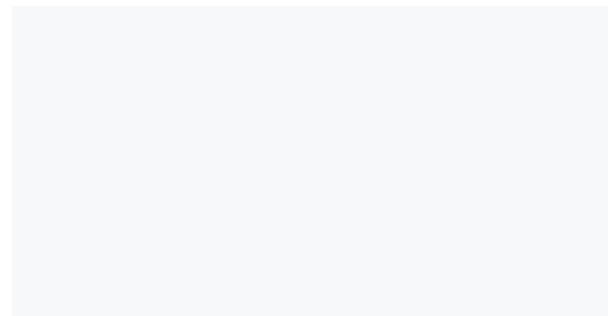

glossy



brushed



satin

tile sizes

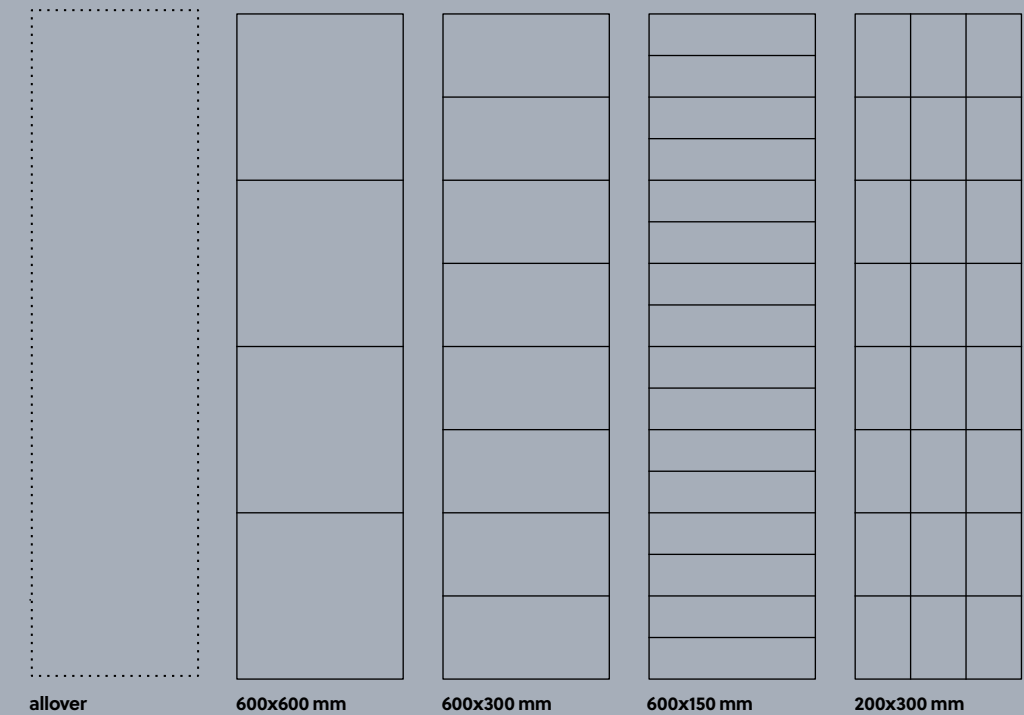

allover

600x600 mm

600x300 mm

600x150 mm

200x300 mm

Don't forget. The difference is in the details. Find our wall accessories on p. 33.

Panel size: 10.2x620x2400 mm Decor size: 600x2400 mm

	Quantity	Coverage m ²	Weight
Per pack	2 panels	2.88 m ²	22.70 kg

Discover your options.



federa
allover
brushed
62001828



white marble
600x600 mm
satin
62001800



natural slate
600x600 mm
brushed
62002030

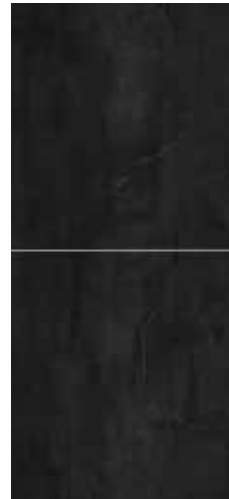

black velvet
600x600 mm
satin
62001740

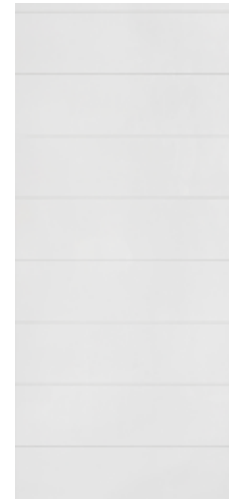

snow white
600x150 mm
glossy
62002183

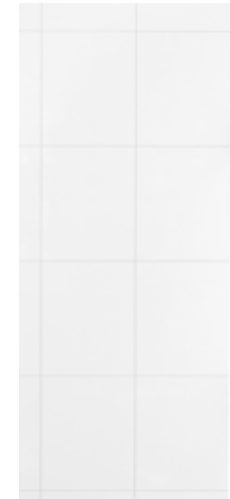

snow white
200x300 mm
glossy
62002184

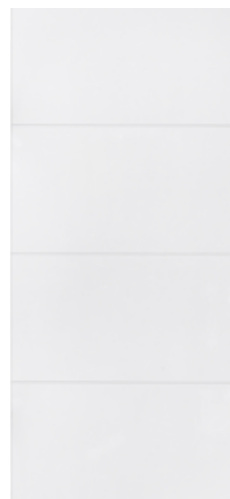

snow white
600x300 mm
glossy
62002176



santorini marble
600x300 mm
satin
62001745



concrete
600x300 mm
satin
1960-7963



cement
600x300 mm
satin
62000447

Name	Finish	Code	Tile size
federa	brushed	62001828	Allover
white marble	satin	62001800	600x600 mm
natural slate	brushed	62002030	600x600 mm
black velvet	satin	62001740	600x600 mm
snow white	glossy	62002176	600x300 mm
santorini marble	satin	62001745	600x300 mm
concrete	satin	1960-7963	600x300 mm
cement	satin	62000447	600x300 mm
snow white	glossy	62002183	600x150 mm
snow white	glossy	62002184	200x300 mm



fast & easy
installation



hidden
corner
profiles

Installing your Wall&Water will give you **instant satisfaction.**

Glue or interlock, our wall panels combine ease of installation with ease of maintenance. Wall&Water is the only system in the world offering you the look of a tiled wall this quickly and easily - all without the need for grouting.

The panels can be glued directly onto a solid wall. In this case, the walls must be absolutely straight and smooth.

For walls with existing coverings of varying thickness (such as tiles halfway up), you can fix wooden boards of the same thickness and use BerryAlloc glue.

Wall&Water panels are best mounted onto a wooden frame using screws. The panels interlock thanks to the unique 'lock' system developed at our engineering department in Norway. The result: a smooth wall with no visible joints. Your bathroom will be ready in a splash!

More detailed installation instructions can be found on our website or YouTube channel: berryalloc.com & youtube.com/berryalloc.

The difference is in the details

BerryAlloc Wall&Water panels can be easily installed with our corner profiles.

What finish do you want?

Choose from white or aluminium coloured profiles. For an extra beautiful and natural look, have a look at our hidden Hydroloc profiles.

Aluminium corner profiles



With the unique HydroLoc hidden corner solution you can give your Wall&Water panels a nice corner finish. Making the walls look both natural and professionally finished.

This solution locates the profiles on the back of the panels, resulting in a small visible grout line similar to those on the panels themselves.

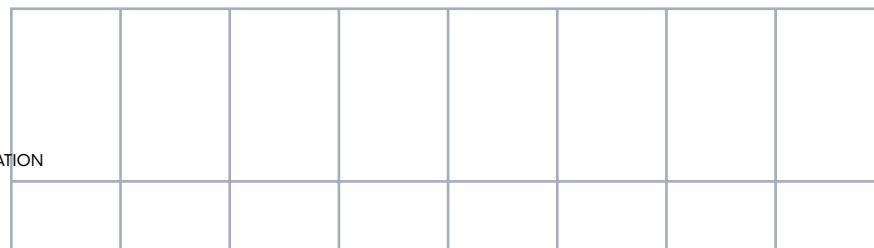

accessories. wall&water

Use our accessories for a smooth and simple installation. These accessories seal the edges of the panels, making them suitable for wet areas.

Base profiles

For sealing the bottom of the panel and eases the installation.



Base profile
alu 2,4 M
9406-3017



Base profile
white 2,4 M
63000038



Corner profiles

Seal and ease the installation of the corner.

Inner corner profile – quadraLoc
alu, 90 G
2,4 M
9400-3017
2,7 M
9401-3017

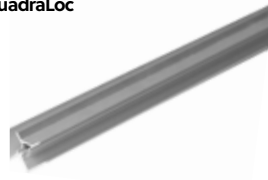

Inner corner profile – quadraLoc
white, 90 G
2,4 M
63000033
2,7 M
63000034



Inner corner profile – quadraLoc
alu, 135 G
2,4 M
63000073
2,7 M
63000074



Inner corner profile – quadraLoc
white, 135 G
2,4 M
63000075
2,7 M
63000076



External corner profile
alu, 90 G
2,4 M
63000718
2,7 M
63000720



External corner profile
white, 90 G
2,4 M
63000719
2,7 M
63000037



NB: 2,7m external corner deviates slightly from the photo

Hidden corner profiles

Hidden inner or external corner profiles gives your panels a perfect finish. Only a small visible groutline will be shown. Remember the small hydroloc screws!

HydroLoc hidden external corner profile
alu, 2,350 M, 90 G
63000717



HydroLoc hidden inner corner profile
alu, 2,350 M, 90 G
63000716



End profiles

For finishing and sealing the wall (horizontally or vertically)



End profiles – U shape
alu 2,4 M
261401



End profiles – U shape
white 2,4 M
63000030



End profile – L shape
alu 2,4 M
261405



End profile – L shape
white 2,4 M
63000031



Extension profile

For installing panels on walls over 2,4 m height.

Extension profile/H-profile
alu 2,4 M
63000724



Extension profile/H-profile
white 2,4 M
63000723



HydroLoc hidden extension profile
alu 0,53 M
63000783



Corner piece

For installing together with our external corner profiles when making a cornered box. Like a shelf or cistern.

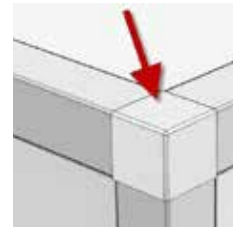

Corner piece
2 per bag
alu
63002736



Corner piece
2 per bag
white
63002743



Sealant

Sealing between panels and aluminum profiles. Sealing the panel joints in wet areas.

Sealant white
290 ml
63000606

Sealant light grey
290 ml
63000607



Miscellaneous

Screws for HydroLoc hidden profiles
profile
63000725



Screws for panels and profiles
30 mm
9310-0015
45 mm
9310-0016



Tapping block
9310-0020



Wipes
To clean during installation
9310-0023



For installing the cover of the inner corner profile.

technical guide. wall&water

product description

- | | | |
|-----|-----------------|--|
| 1.1 | Dimensions | 10.2 x 2400 x 600 mm (decor) 10.2 x 2400 x 620 mm (panel) |
| 1.2 | Packaging | 2 panels/pack, 2.88 m ² coverage (weight 22.6 kg) |
| 1.3 | Composition | - surface layer
High Pressure Laminate, HPL.
- substrate
Plywood, 7 layers
- backing
Spantex – engineered balancing paper with plastic impregnation (PE). |
| 1.4 | Joint sealing | To be sealed with BerryAlloc Sealant. |
| 1.5 | Installation | Glue-free mechanical locking system, installed according to installation instructions. |
| 1.6 | Classifications | SINTEF technical approval no. 2410.
- Wet-room approved product acc. to BVN (Byggebransjens Våtromsnorm)
European Technical Assessment no. ETA-18/0735. |



general requirements

characteristics	test standard	unit	requirements	typical values
2.1 Thickness of the element, t	EN 324-1	mm	± 0.4	± 0.4
2.2 Length of the surface layer, l	EN 324-1	mm	± 1.0	± 0.5
2.3 Width of the surface layer, w	EN 324-1	mm	± 0.5	± 0.25
2.4 Squareness of the element, q	Diagonal variance	mm	≤ 1.0	≤ 0.5
2.5 Openings between elements, o	EN 13329	mm	-	< 0.1
2.6 Height difference between elements, h	EN 13329	mm	≤ 0.15	≤ 0.1
2.7 Dimensional variations after changes in relative humidity	EN 318	mm	-	$\delta l_{average}$ 2.4 $\delta w_{average}$ 2.6
2.8 Light fastness	EN 20105 EN ISO 105	Grade scale Grade scale	Grey scale: ≥ 4 Blue wool scale: ≥ 6	>4 >6
2.9 Surface hardness	NT Build 059	mm	-	0.42
2.10 Impact resistance	NT Build 066	m	-	1.0
2.11 Resistance to staining	EN 438.2.26	Rating ¹⁾	Group 1 & 2: 5 Group 3 & 4: 4	5 5

Definitions: $\delta l_{average}$ = dimensional changes, l $\delta w_{average}$ = dimensional changes, w

¹⁾ Rating scale from 1 to 5, where 5 is the best rating = "no visible change in the surface".

other technical data

characteristics	test standard	unit	requirements	typical values
3.1 Formaldehyde, emission	EN 717-2	mg/m ² h	-	E1
3.2 Scratch resistance	EN 438.2.25	Rating ¹⁾	-	1
3.3 Reaction to fire	NS 3919 EN 13501-1	Class Class	-	K2 (linings) In2 (surface) D-s2, d0
3.4 Grout line deviation	-	mm	≤ 0.3	< 0.2

¹⁾ Rating scale from 1 to 5, where 5 is the best rating = "no visible change in the surface".



BERRY  **ALLOC**

Alloc AS
Fiboveien 26
4580 Lyngdal, Norway
Tel. +47 38 34 22 00
info@berryalloc.com

berryalloc.com